



Copyright Design Evolutions Inc., GA

Artist rendering, may vary from actual plan

The Symone 1

Plan number: DE132

First floor sq ft: 1,790

Second floor sq ft: N/A

Total sq ft: 1,790

Bonus room sq ft: 458 (in add. to total sq ft)

Dimensions: 53'-0" x 58'-0"

Bedrooms: 3

Bathrooms: 2

Foundations: basement, crawlspace, slab

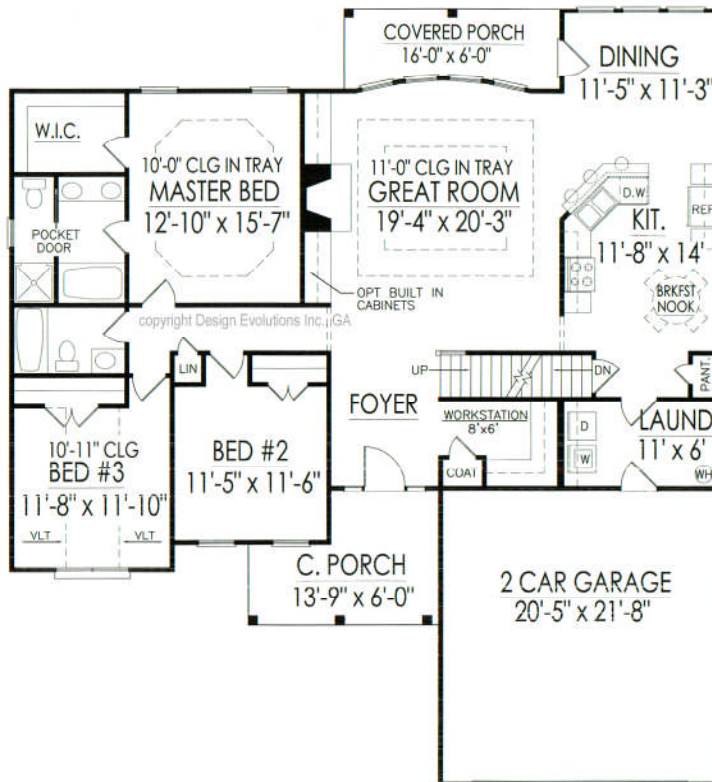

FLOOR PLAN

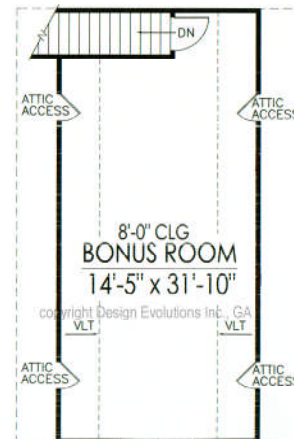

BONUS ROOM